

SERRAMENTI IN PROFILATI DI ALLUMINIO REI 60 FENSTER UND TÜREN AUS ALU-PROFILIEN

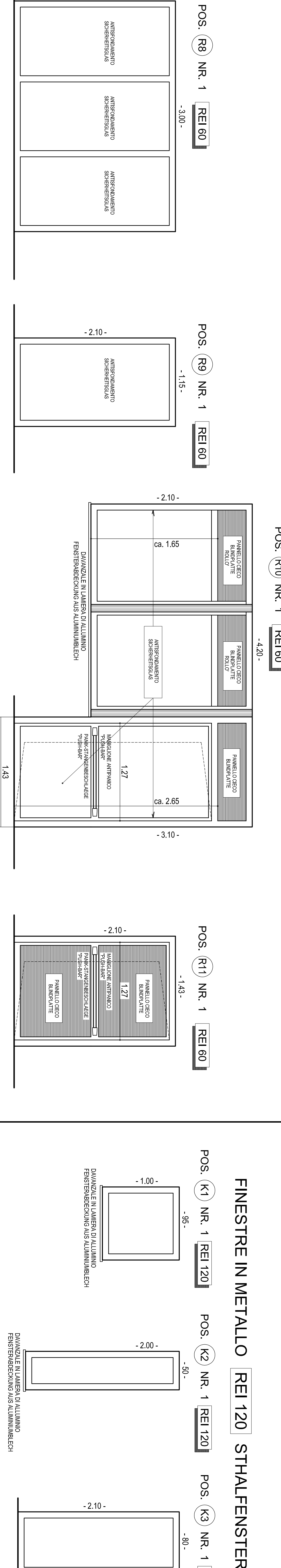

SERRAMENTI IN PROFILATI DI ALLUMINIO CON TAGLIO TERMICO FENSTER UND TÜREN AUS ALU-PROFILIEN, MIT TERMISCHE TRENNUNG

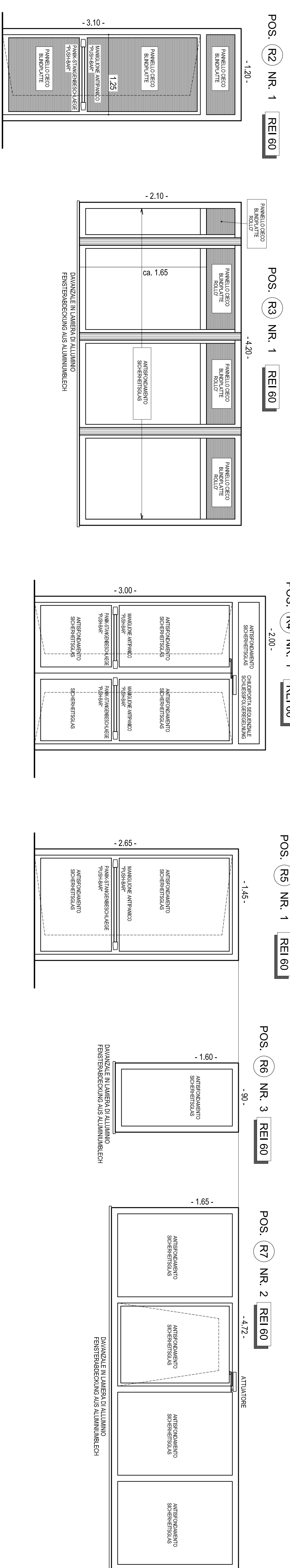
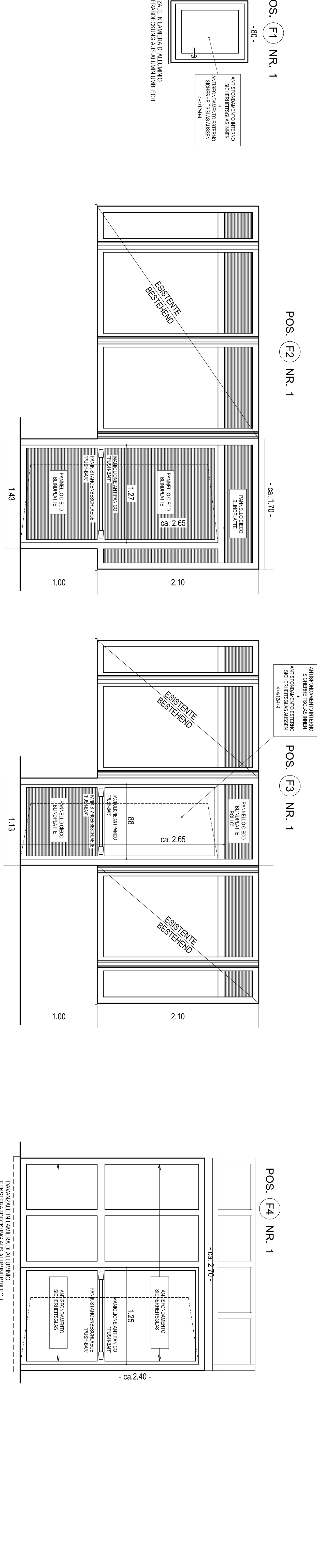

PORTE IN METALLO REI 60 STHALTÜREN

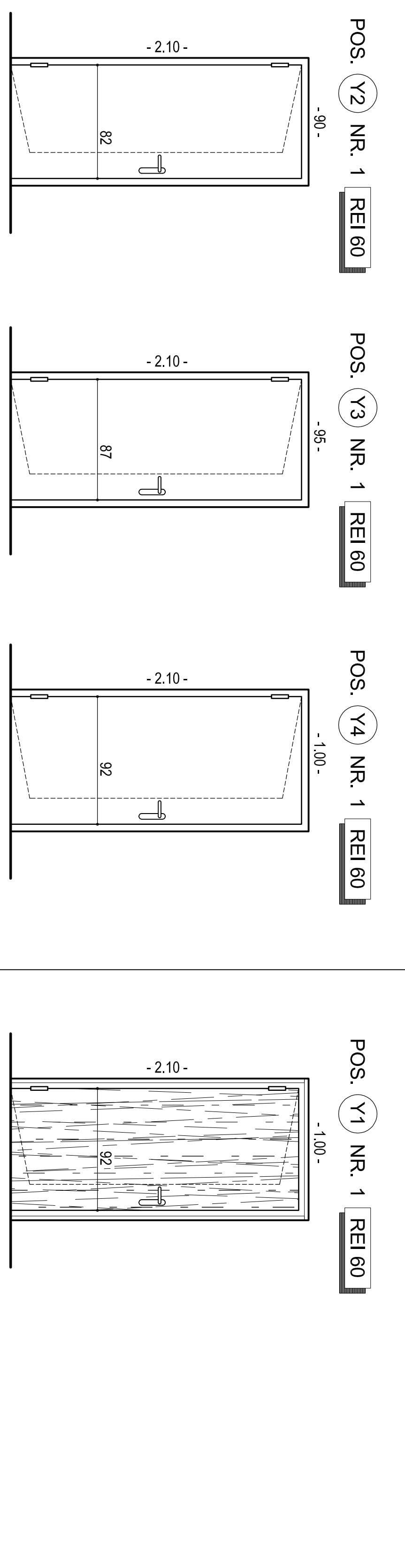

PORTE IN LEGNO REI 60 HOLZTÜREN

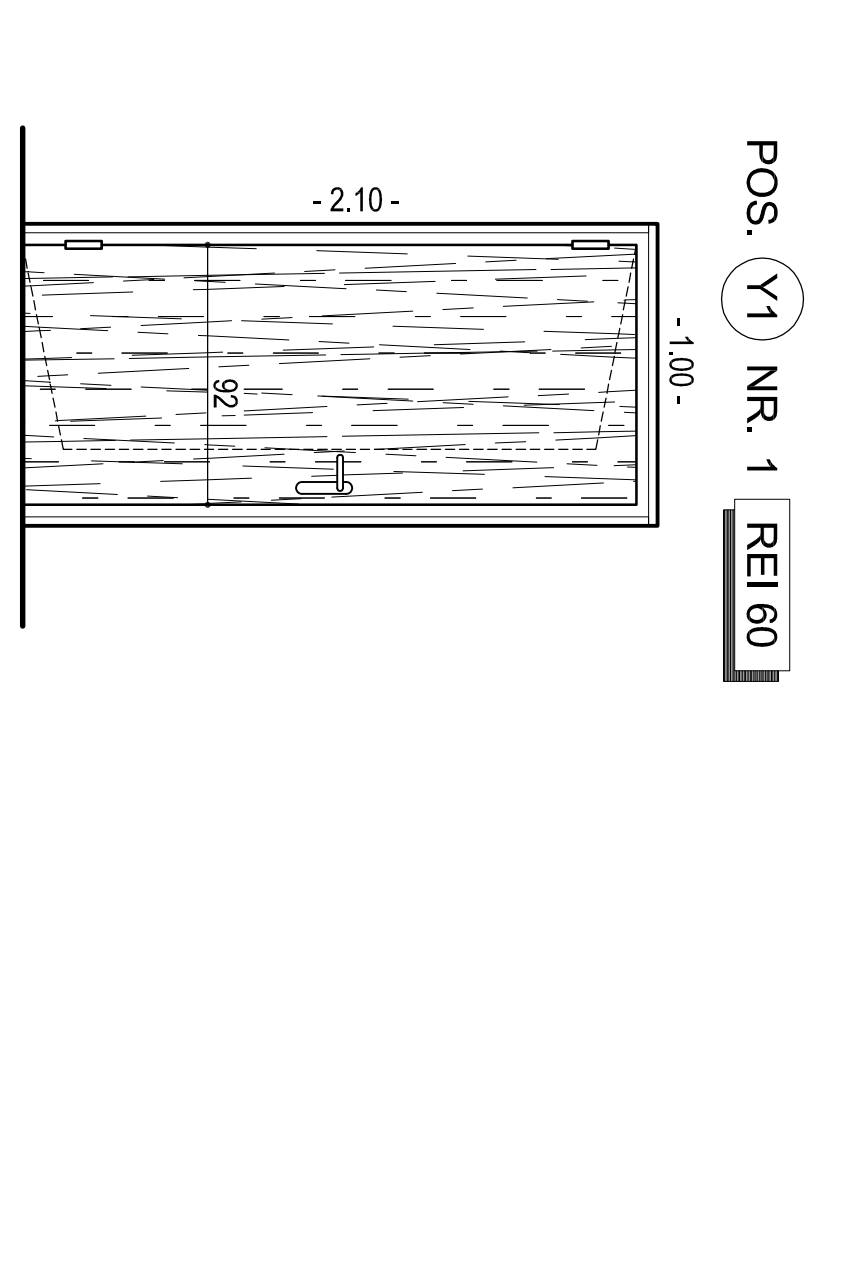

PORTE IN METALLO REI 120 STHALTÜREN

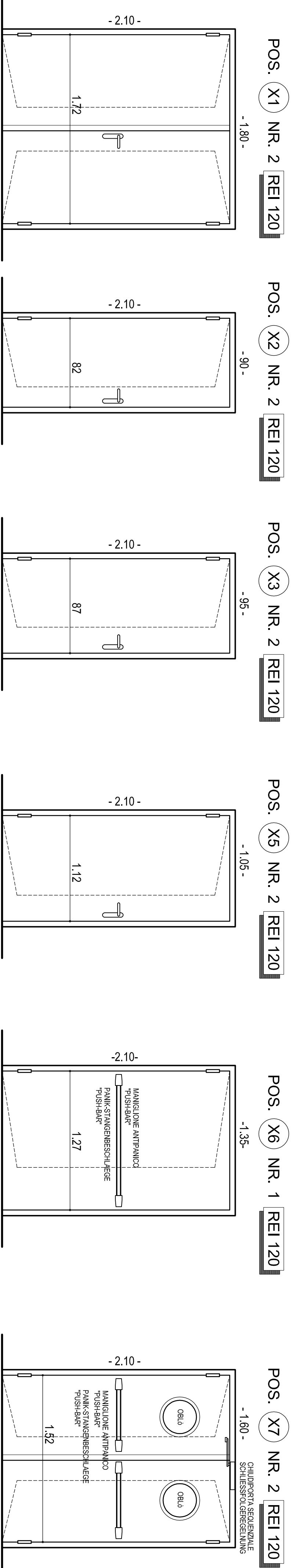

FINESTRE IN METALLO REI 120 STHALFENSTER

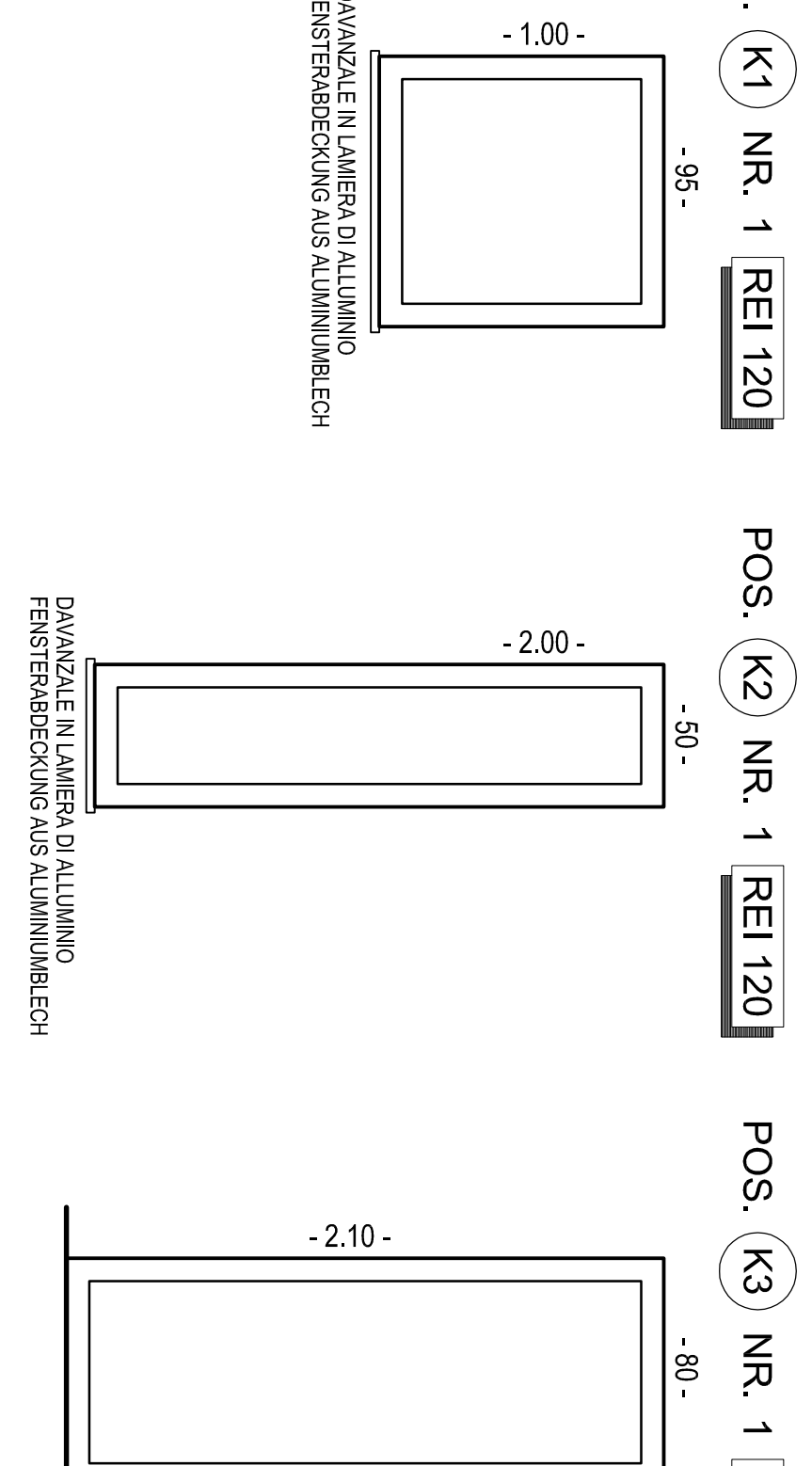

PROV. AUTONOMA DI BOZANO
COMUNE DI BOZANO

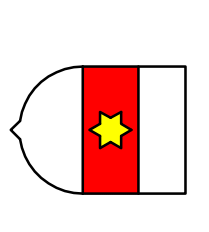

AUTONOME PROVINZ BOZEN
GEMEINSCHAFT SÜDTIROL

ADEGUAMENTO ALLE NORME DI PREVENZIONE INCENDI
SCUOLA MEDIA "A. E. LENZ"
VIA CASTEL FLAVION - BOZANO
ANPASSUNG AN DIE BRAND/VERHÜTUNGS VORSCHRIFTEN
MITTELSCHULE "A. E. LENZ"
KLEPACHWEG - BOZEN

PROGETTO ESECUTIVO
AUSFÜHRUNGSPROJEKT
SERRAMENTI
TÜREN UND FENSTERN

IN PROGETTISTA: UBERPROJEKTANT
TAVOLA N. 07
DATA DEL DISEGNO: 18.04.2011
SCALATURA: 1:25

Studio Tecnico Onco - Ing. Claudio Onco - Corso Libertà 30/35000 - Bolzano Tel. 0471 232978